

CT1-76YML

10" Hydraulic Chuck

Y-Axis / 16-Station Power Turret

Programmable Tailstock and Steady Rest

- 22 kw built-in spindle, Max.spindle speed 4000 rpm, Max. Turning Dia. 325 mm.
- Max. speed of live tool 6000 rpm, and Max. horsepower 4.5kw.
- Equipped with programmable tailstock and steady rest, Max. turning length is 1200mm.



CT1-76YML

Machine Layout

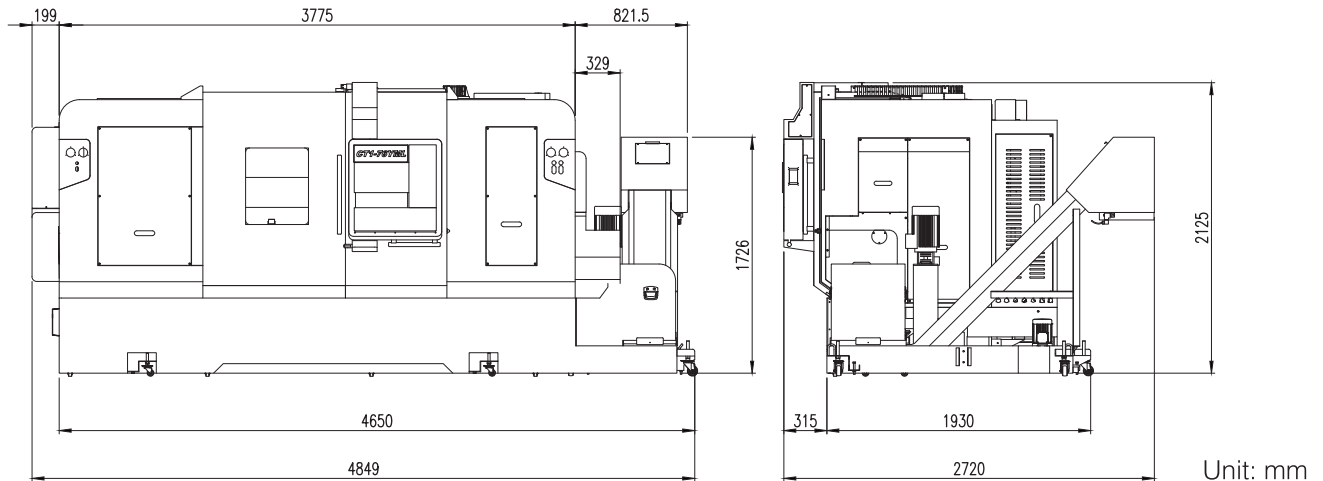

Specifications

Control Unit	Model	CT1-76YML
Control Unit	Controller	FANUC
Capacity	Max. Turning Dia.	Ø325 mm
	Standard Turning Dia.	Ø210 mm
	Max. Turning Length	1200 mm
	Bar Feeding Dia.	Ø76 mm
Axis Specifications	X1/Y1/Z1-Axis Travel	225 mm/±50 mm/1330 mm
	X1/Y1/Z1-Axis Motor	2.7 kw
	X1/Y1/Z1-Axis Rapid Travel Speed	16 / 6 / 40 m/min
	Min. Input Unit	0.001 mm
Spindle	Max. Bar Feeding Dia.	Ø76 mm
	Spindle Motor	18 / 22 kw
	Max. Spindle Speed	4000 rpm
	Spindle Nose	A2-6
	Chuck Size	8" (Op:10")
	C Axis Rapid Travel Rate	0.001°
	Min. Moving Unit	600 min ⁻¹
Steady Rest	Centering Range	Ø50~Ø200 mm
	Tailstock travel	920
	Rapid Travel Rate	10 m/min
	Min. input unit	0.001 mm
Tailstock	Tailstock travel	840
	Quill Stroke	130
	Quill Type	MT5
	Quill Dia.	85
Live Tooling Turret	O.D Turning Tool Size	□25 mm
	I.D Turning Tool Size	Ø25 mm
	Rotating Mode	Single Tool Transmission
	Live Tooling rpm	60~6000 min ⁻¹
	Live Tooling Motor	4.5 kw
	Collet Size	ERØ32
Hydraulic	Tool Holder & Tool Size	BMT65
	Hydraulic Motor	5HP / 3.7kw
Coolant Pump	Spindle Coolant Pump	3HP / 2.24kw
	Turret Coolant Motor	3HP / 2.24kw
	Chip Flush Pump	3HP / 2.24kw
Tank Capacity	Hydraulic Tank	45L
	Coolant Tank	550L
Machine	Voltage Stabilizer / Transformer	220V / 45KVA
	Machine Size (LxWxH)	4849×2720×2125 mm
	Machine N.W.(includes chip conveyor)	8500kg Machine:7500kg

* Design and specs subject to change without notice.

